

# 1132 Series Low Pressure Brass Diaphragm Packless Cylinder Valves

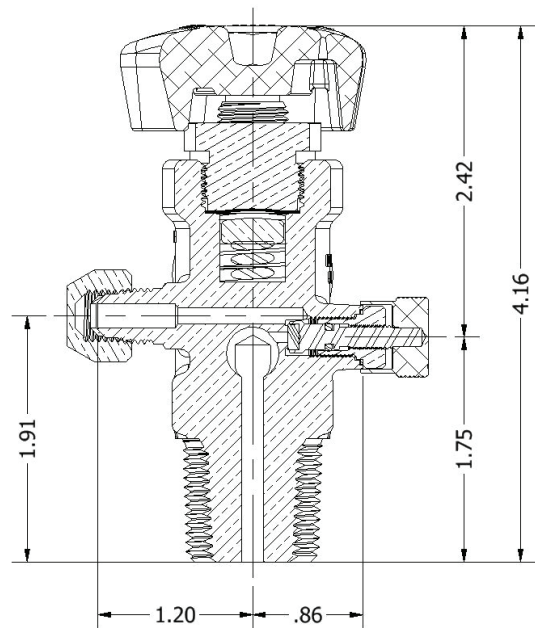

The 1132 Series Low Pressure Brass Diaphragm Packless Valves are designed for use in liquefied gas applications, including refrigerants and flammables. It is especially suited for propane, butane, fuel-gas applications and sterilant gas applications.

- Replaceable spring-loaded Type CG-7 safety for use on liquefied gas cylinders have water capacities not exceeding 254 lbs
- PTFE seat insert and controlled stem travel assure positive shut-off and long wear-resistant service
- Two piece stem reduces wear and increases valve life
- Optional integrated valve charging port with 1/4" SAE fl are connection
- Liquid and vapor withdrawal available
- Excess flow device available for liquid withdrawal option for propane and butane
- 50 mm handwheel designed for ease of operation and to reduce the risk of valve damage from over-torque

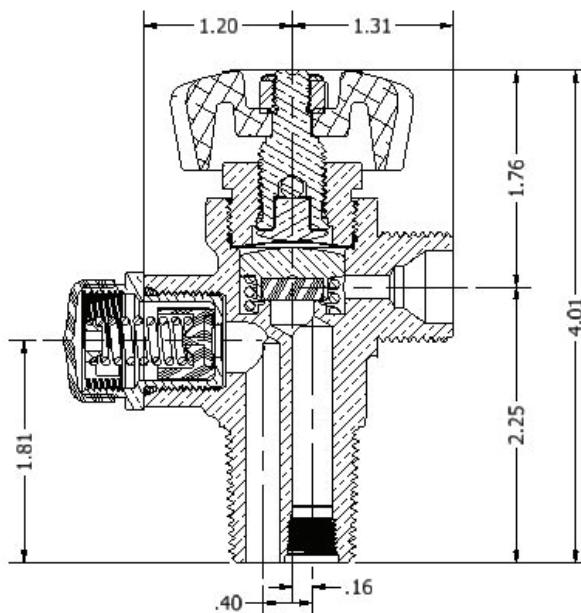

Sherwood Part Number	Inlet	Outlet	PRD	PRV Start to Discharge Pressure (PSI)	PRV Flow Capacity (SCFM)	Diptube tap	Pressurizing Port
1132E510-375	¾" NGT	CGA 510	CG-7	375	318 <sup>a</sup>	N/A	No
1132E510-435	¾" NGT	CGA 510	CG-7	435	381 <sup>b</sup>	N/A	No
1132T555-375	¾" NGT	CGA 555	CG-7	375	318 <sup>a</sup>	⅛" NPT	No
1132T555-435	¾" NGT	CGA 555	CG-7	435	381 <sup>b</sup>	⅛" NPT	No
1132X9510-375	¾" NGT	CGA 510	CG-7	375	318 <sup>a</sup>	⅛" NPT	Yes
1132X9555-375	¾" NGT	CGA 555	CG-7	375	318 <sup>a</sup>	⅛" NPT	Yes
1132X9555-435	¾" NGT	CGA 555	CG-7	435	381 <sup>b</sup>	⅛" NPT	Yes
1132X9510-435	¾" NGT	CGA 510	CG-7	435	381 <sup>b</sup>	⅛" NPT	Yes
1132X8510	¾" NGT	CGA 510	CG-3	N/A	N/A	⅛" NPT	No

a = Rated Flow Pressure = 480 PSI  
b = Rated Flow Pressure = 413 PSI

### Design Specifications

	English	Metric
Maximum Working Pressure	500 PSI	34 Bar
Operating Temperature	-50° F to +130° F	-45° C to +54° C
Storage Temperature	-65° F to +155° F	-54° C to +68° C
Operating Torque	10-20 in.-lbs.	1.1-2.3 N-m
Closing Torque	30-40 in.-lbs.	3.4-4.5 N-m
Leak Rate	1x10 <sup>-5</sup> atm cc/s	1x10 <sup>-6</sup> Bar mL/sec
Handwheel nut Installation torque	30-40 in.-lbs.	3.4-4.5 N-m
PRV Installation Torque	10-12 ft.lbs.	13.6-16.3 N-m
Cv Flow Factor	1.12/1.5 (1132E)	1.12/1.5 (1132E)
Minimum Cycle Life	2000 Minimum	

### Standards Conformance

CGA V-9	Standard for Gas Cylinder Valves
CGA S1.1	Standard for Pressure Relief Devices
CGA V-1	Compressed Gas Cylinder Valve Outlet and Inlet Specifications
ISO 10297	International Standard for Cylinder Valves Design Specifications

### Replacement Parts

Sherwood Part Number	Description	Quantity
3250R-10-KIT	CG-7 Pressure Relief Valve (435 PSI)	50
3250R-10-375-KIT	CG-7 Pressure Relief Valve (375 PSI)	50
TL3250R	Tool to install replacement PRV	1
1132-17	⅜" NPT to ¼" NPT Diptube adapter	200

### Materials of Construction

Part Description	Materials of Construction
Body	Brass C37700
Bonnet	Brass C36000
Handwheel	Powder Coat Aluminum
Handwheel Nut	Steel with nylon insert
Stem	Brass C48500
Seat holder	Brass C36000
Seat	PTFE
Diaphragm	Stainless Steel
Spring	Stainless Steel
Ball Bearing	Stainless Steel
<b>Charge Port parts for X9 Versions</b>	
Bonnet	Brass C36000
Knob	Anodized Aluminum
Washer	Copper
O-ring	Viton
Stem	Stainless Steel
Seat	Nylon 6/6

## Liquid Withdrawal Excess Flow Device



### Liquid Withdrawal Excess Flow Device

Sherwood Part Number	Shut off Flow & Pressure	Inlet	Outlet
510B-1000	1.2 GPM at 4 PSI	⅛" NPT	⅛" NPT
510P-1000	2 GPM @ 10 PSI	⅛" NPT	⅛" NPT