



**& CRYO HOSE
FITTINGS**

**EVERGREEN MIDWEST
8976 OSBORNE DR
MENTOR, OHIO**

CGA 440
Oxygen Cryogenic Transfer Hose
(S) = Stainless Steel Ends
500 PSI

CGA 440 female both ends 48" long CH()-440-440-48
CGA 440 female both ends 60" long CH()-440-440-60
CGA 440 female both ends 72" long CH()-440-440-72
CGA 440 female both ends 120" long CH()-440-440-120
CGA 440 female both ends 144" long CH()-440-440-144

CGA 295
Nitrogen Cryogenic Transfer Hose
(S) = Stainless Steel Ends
500 PSI

CGA 295 female both ends 48" long CH()-295-295-48
CGA 295 female both ends 60" long CH()-295-295-60
CGA 295 female both ends 72" long CH()-295-295-72
CGA 295 female both ends 120" long CH()-295-295-120
CGA 295 female both ends 144" long CH()-295-295-144

EXAMPLE

CHS-295-295-72
CGA 295
Stainless Steel Ends
72" Long

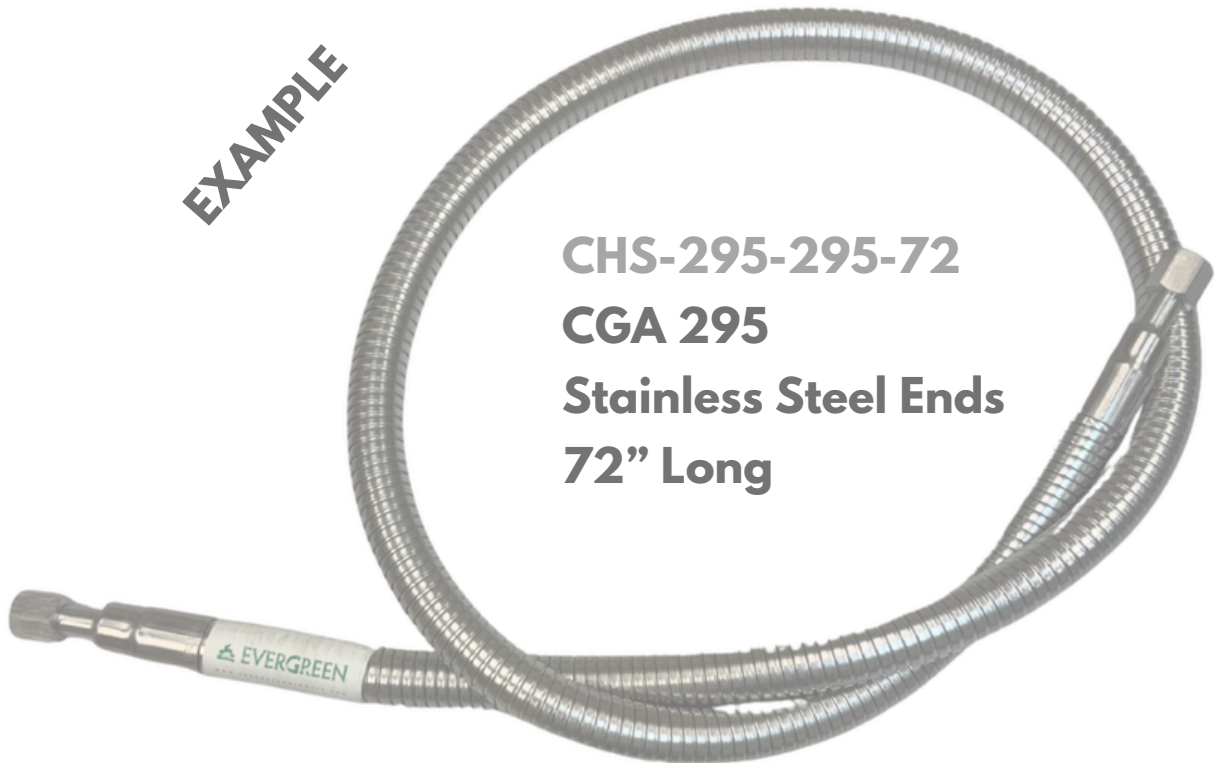

CGA	Connection	Gas	Part No.
CGA 165 male	1/4" flare x 1/8" MNPT	Refrigerants	FA-1651
CGA 165 male	1/4" flare x 1/4" MNPT	Refrigerants	FA-1652
CGA 182 male	3/8" flare x 1/4" MNPT	Refrigerants	FA-1822
CGA 295 male	1/2" flare x 1/4" MNPT	Cryogenic Inert	FA-2952
CGA 295 male	1/2" flare x 3/8" MNPT	Cryogenic Inert	FA-2953
CGA 295 male	1/2" flare x 1/2" MNPT	Cryogenic Inert	FA-2954
CGA 440 male	5/8" flare x 1/4" MNPT	Cryogenic Oxygen	FA-4402
CGA 440 male	5/8" flare x 3/8" MNPT	Cryogenic Oxygen	FA-4403
CGA 440 male	5/8" flare x 1/2" MNPT	Cryogenic Oxygen	FA-4404
CGA 440 male	5/8" flare x 3/4" MNPT	Cryogenic Oxygen	FA-4405
CGA 450 LH male	5/8" flare x 1/4" MNPT	Methane, Natural Gas	FA-4502

500 PSI

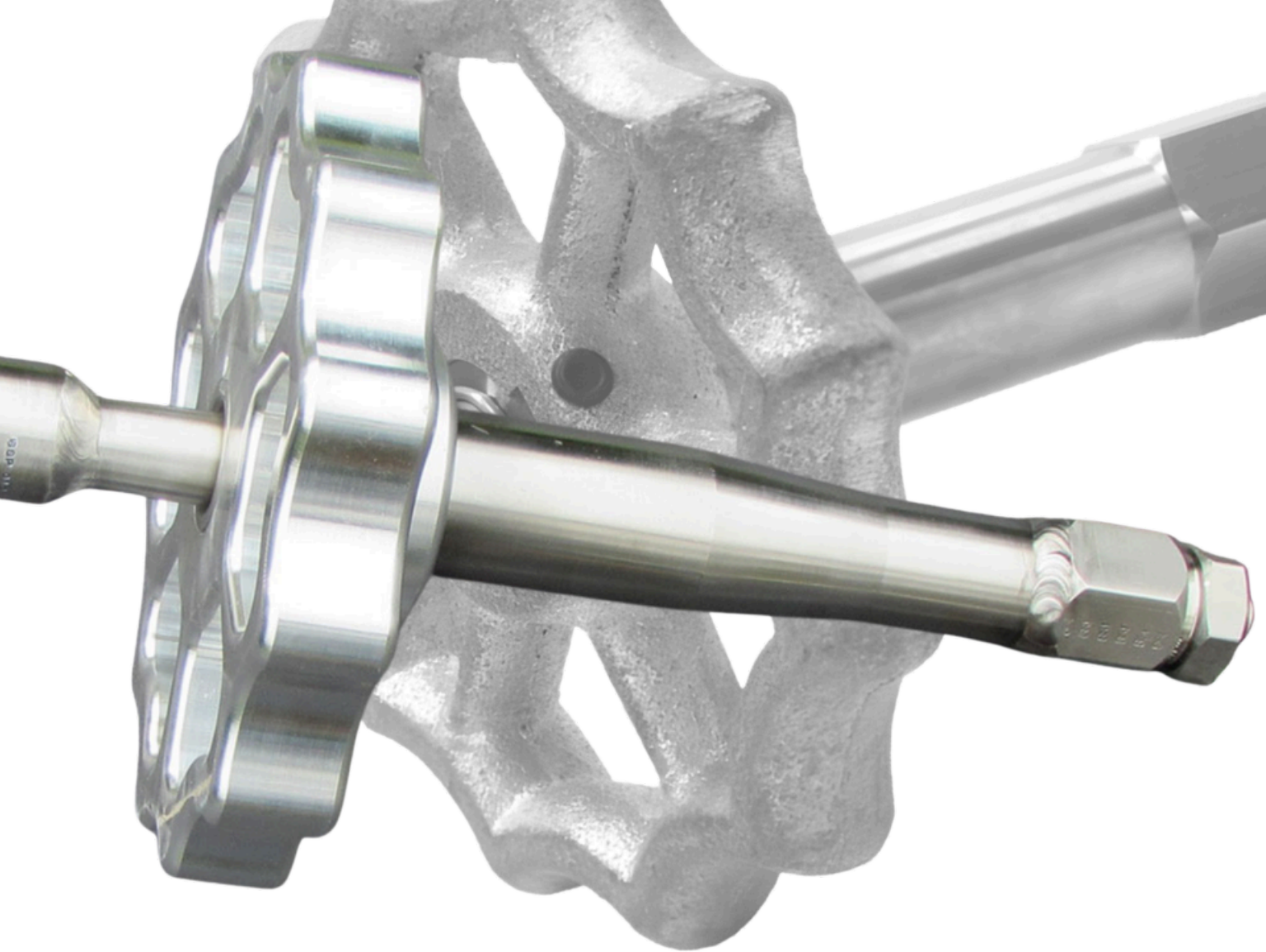

Oxygen CGA 440 Tee Handle	CHTE-440
Nitrogen/Inert CGA 295 Tee Handle	CHTE-295
Oxygen CGA 440 Handwheel	HTC-440
Nitrogen/Inert CGA 295 Handwheel	HTC-295
3/8" Female NPT Phase Separator	CPS-001
CGA 440 Stainless Steel Fill Elbow	CEL-440
CGA 295 Stainless Steel Fill Elbow	CEL-295